

CSK / CSK-2RS

Sprag Keyway Type One Way Clutch Bearings One Way Overrunning Sprag Freewheel Cam Clutch Bearings

CLI's CSK One Way Bearing Series is a sprag type freewheel integrated into the 6200 radial bearing series. The internal part of the bearing is protected by a seal but additional seals are recommended especially when the working temperature exceeds 50°C.

All CLI's CSK One Way Bearings are equipped with chrome formed sprags that increases the over-run life several times. Torque transmission is ensured by a press fit assembly into a rigid outer housing and onto a shaft with an N6 tolerance. Initial bearing radial clearance is set at C5 and is reduced if using the press fit as specified.

CLI's CSK One Way Bearing Series has a small radial section height and is also commonly known as a One Way Bearing or Anti-Reverse Bearing. One Way Bearings are designed to transmit torque between the shaft and housing in one direction and allow free motion in the opposite direction.

In addition to the basic CSK model, type CSK..P features a keyway on the inner race and CSK..PP features a keyway on both the inner and outer race. For this reason it can be keyed to a shaft.

The recommended mounting tolerances are "h6" on the shaft and "H6" in a rigid housing.

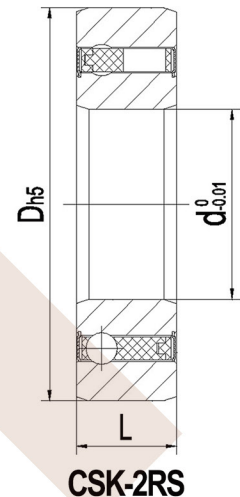
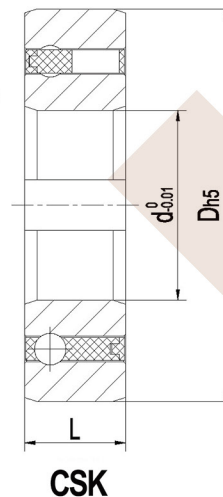

Type	Dimension(mm)			Torque N.m	Limiting Speed(RPM)	Load Rating(KN)		Weight Kg
	d	D	L			Dynamic(C)	Static(Co)	
CSK8	8	22	9	2.5	15000	3.28	0.86	0.015
CSK12	12	32	10	9.3	10000	6.1	2.77	0.04
CSK15	15	35	11	17	8400	7.4	3.42	0.06
CSK17	17	40	12	30	7350	7.9	3.8	0.07
CSK20	20	47	14	50	6000	9.4	4.46	0.11
CSK25	25	52	15	85	5200	10.7	5.46	0.14
CSK30	30	62	16	138	4200	11.7	6.45	0.21
CSK35	35	72	17	175	3600	12.6	7.28	0.3
CSK40	40	80	22	325	3000	15.54	12.25	0.5
CSK6003	17	35	10	15				0.055
CSK6004	20	42	12	28				0.065
CSK6005	25	47	14	78				0.1
CSK6304	20	52	15	85				0.18
CSK6305	25	62	17	145				0.26
CSK6306	30	72	19	205				0.415

Type	Dimension(mm)			Torque N.m	Limiting Speed(RPM)	Load Rating(KN)		Weight Kg
	d	D	L			Dynamic(C)	Static(Co)	
CSK8-2RS	8	22	9	2.5	15000	3.28	0.86	0.015
CSK12-2RS	12	32	14	9.3	10000	6.1	2.77	0.05
CSK15-2RS	15	35	16	17	8400	7.4	3.42	0.07
CSK17-2RS	17	40	17	30	7350	7.9	3.8	0.09
CSK20-2RS	20	47	19	50	6000	9.4	4.46	0.145
CSK25-2RS	25	52	20	85	5200	10.7	5.46	0.175
CSK30-2RS	30	62	21	138	4200	11.7	6.45	0.27
CSK35-2RS	35	72	22	175	3600	12.6	7.28	0.4
CSK40-2RS	40	80	27	325	3000	15.54	12.25	0.6

* Notes: **CSK**=Sprag Keyway Type One Way Clutch Bearing, **2RS**=Two Rubber Seals